

Hyb Lles Rhydypennau

Rhydypennau Wellbeing Hub

Dweud eich Dweud!

Mae Cyngor Caerdydd yn cynnig estyn gwasanaethau yn Llyfrgell Rhydypennau a chreu Hyb Lles newydd. Rydym am gael eich barn ar ba wasanaethau a chyfleusterau ychwanegol y dylai eu darparu.

Gyda phoblogaeth sy'n gynyddol hŷn, mae angen canolbwyntio ar les cymdeithasol, ffyrdd iach ac actif o fyw, ymgysylltu â'r gymuned a byw'n annibynnol. Mewn ymateb i hyn, bydd yr Hybiau Lles yn cynnig rhaglenni wedi'u teilwra at anghenion y gymuned a bydd yn gweithio gyda sefydliadau partner, grwpiau lleol a gwirfoddolwyr i wella'r gwasanaethau yr ydym yn eu cynnig i chi.

Mae cynigion arfaethedig wedi'u datblygu i wella adeilad Llyfrgell Rhydypennau, gan gynnwys estyniad, mynedfa well, gwaith adnewyddu mewnol, parcio hygyrch a thirlunio. Mae'r cynigion hyn yn amodol ar gymeradwyaeth ariannu.

Bydd yr Hyb newydd yn cynnwys:

- Ystod ehangach o wasanaethau cymunedol a lles
- Gwasanaeth cwsmeriaid wyneb yn wyneb gan staff wedi'u hyfforddi'n llawn
- Buddsoddi mewn adeilad cymunedol gwell a mwy cynaliadwy

Mae'r ymgynghoriad hwn yn gyfle i chi lunio'r dyfodol. Rydym eisiau i chi ddweud wrthym pa wasanaethau sy'n bwysig i chi a'ch cymuned. Mae eich barn yn bwysig a bydd yn bwydo i mewn i'r broses gyllunio.

Have Your Say!

Cardiff Council is proposing to extend services at Rhydypennau Library, and create a new Wellbeing Hub. We want your views on what additional services and facilities it should provide.

With an increasing older population, there is a need to focus on social wellbeing, healthy and active lifestyles, community engagement and independent living. In response to this, Wellbeing Hubs will offer programmes tailored to community needs and will work with partner organisations, local groups and volunteers to enhance the services we offer you.

Proposed improvements to Rhydypennau Library building have been planned, including an extension, improved entrance, internal refurbishment, accessible parking and landscaping. These proposals are currently subject to funding approvals.

The new Hub will provide:

- A wider range of community and wellbeing services
- Face-to-face customer service from fully trained staff
- Investment in a better quality, more sustainable community building

This consultation is your opportunity to shape the future. We want you to tell us what services matter to you and your community. Your views are important and will feed into our planning process.



Cynllun Llaur Posibl

Possible Floor Layout

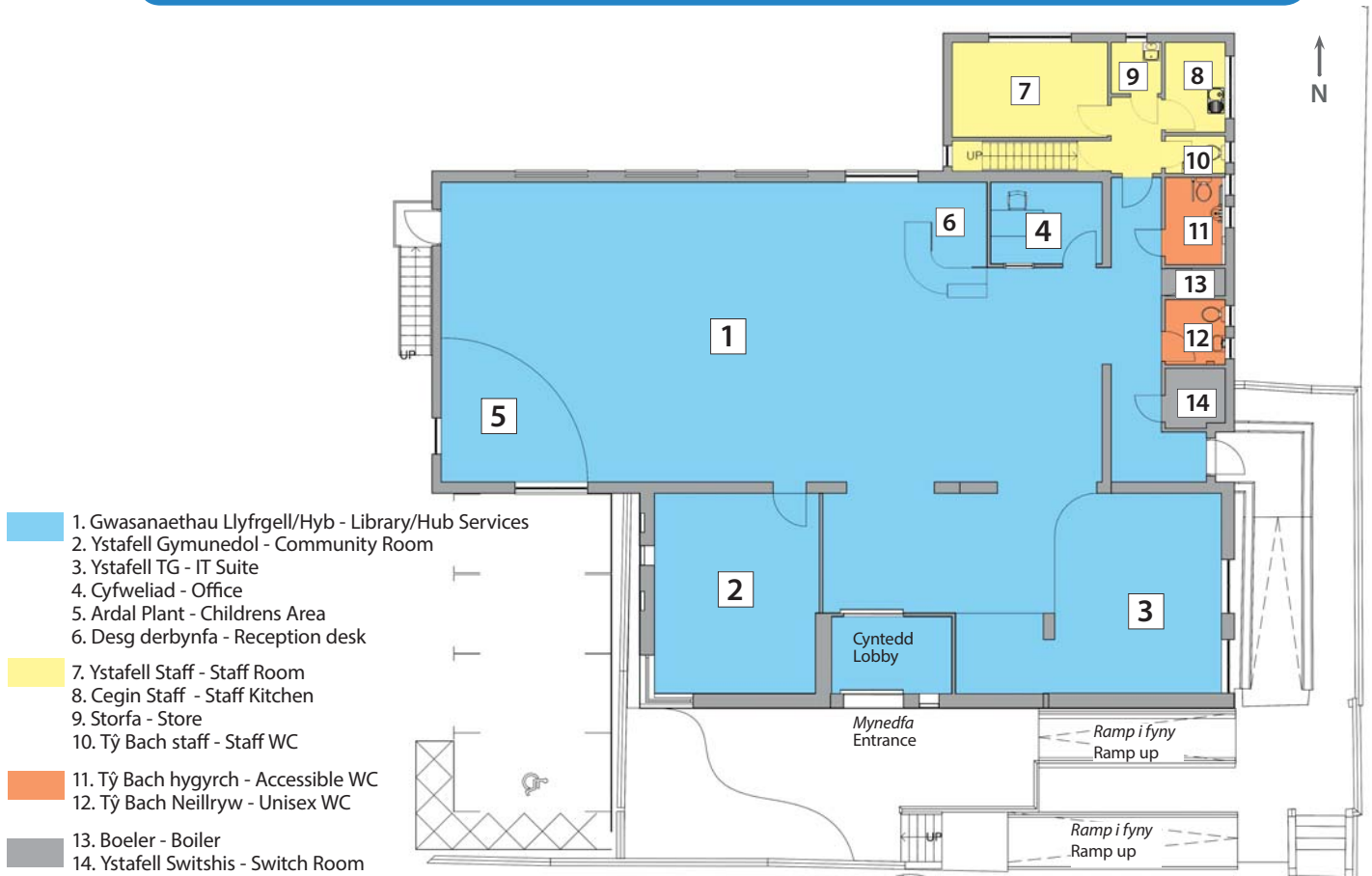

Pa wasanaethau yr hoffech chi eu gweld yn yr Hyb Lles newydd?

- Gwasanaethau llyfrgell llawn
- Gweithgareddau Lles Cymunedol, er enghraifft clybiau cymdeithasol, dosbarthiadau cryfder a chydbwysedd a dosbarthiadau ffitrwydd
- Ystod eang o gyngor ar fyw'n annibynnol.
- Gweithgareddau partner a gwasanaethau galw heibio
- Ceisiadau am Bâs Bws a Bathodyn Glas
- Gwasanaethau cyngor craidd, er enghraifft rheoli gwastraff
- Ceisiadau derbyn i'r ysgol a chyngor ar hynny
- Mynediad i'r rhyngwrwyd/ffôn am ddim
- Ystafell TG
- Lleoedd cymunedol hyblyg
- Gwasanaethau tai
- Grwpiau lechyd a Lles
- Rhagnodi cymdeithasol meddygon teulu

What services would you like in the new Hub?

- Full library services
- Community Wellbeing activities, for example social clubs, strength & balance classes and fitness classes
- A wide range of independent living advice
- Partner activities and drop in services
- Bus Pass and Blue Badge applications
- Core council services, for example waste management
- School admissions advice and applications
- Free internet access / telephone
- IT suite, free internet access and telephone
- Flexible community spaces
- Housing services
- Health and Wellbeing groups
- GP social prescribing

Hyb Lles Rhydypennau Rhydypennau Wellbeing Hub

Argraff Arlunydd

Artist's Impressions





Hyb Lles Rhydypennau Rhydypennau Wellbeing Hub

Argraff Arlunydd

Artist's Impressions



Hyb Lles Rhydypennau Rhydypennau Wellbeing Hub

Cymerwch Ran!

Get Involved!



Os gwelwch yn dda, trafodwch eich barn gyda'r staff yn yr arddangosfa, a chwblhewch yr arolwg i ddweud wrthym pa gyfleusterau fydddech chi a'ch teulu yn eu defnyddio.

Gallwch hefyd gwblhau'r arolwg ar-lein yn:

www.caerdydd.gov.uk/hybllesiant

Bydd yr arolwg ar gael ar-lein o **4 Chwefror 2019**.

Y dyddiad cau ar gyfer cyflwyno arolygon yw **18 Chwefror 2019**.

Neu os hoffech gael yr arolwg mewn unrhyw fformat arall,

Cysylltwch â: Rashmi Wilson

Ffôn: 07891 558636

E-bost: rwilson@caerdydd.gov.uk

Please discuss your views with staff at the exhibition, and fill in the survey telling us what facilities you and your family would use.

You can also fill in the survey online at:

www.cardiff.gov.uk/wellbeinghub

This survey will be available online from the **4th February 2019**.

The deadline for submitting surveys is the **18th February 2019**.

If you have any questions or would like the survey in any other format

Contact: Rashmi Wilson

Phone: 07891 558636

E-mail: rwilson@cardiff.gov.uk

Diolch i chi am eich amser.

Thank you for your time.